

Metric

TS10-20 [metric]

Item Number: **650045**

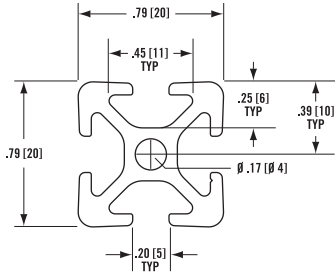

SPECIFICATIONS

Length	20' (6 m)
Weight	0.327 lbs/ft (0.487 kg/m)
Estimated Area	0.279 in ² (1.802 cm ²)
Moment of Inertia	I _x =0.017 in ⁴ (0.727 cm ⁴) I _y =0.017 in ⁴ (0.727 cm ⁴)

TS25-25M [metric]

Item Number: **650025**

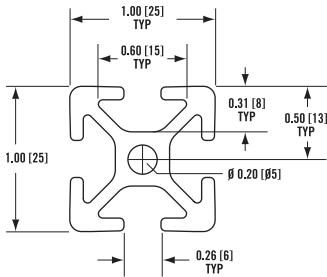

SPECIFICATIONS

Length	20' (6 m)
Weight	0.548 lbs/ft (0.816 kg/m)
Estimated Area	0.457 in ² (2.948 cm ²)
Moment of Inertia	I _x =0.046 in ⁴ (1.915 cm ⁴) I _y =0.046 in ⁴ (1.915 cm ⁴)

TS25-25MQR [metric]

Item Number: **650027**

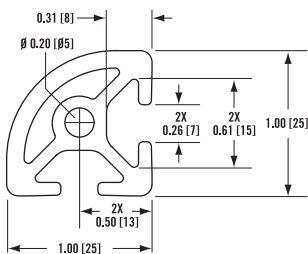

SPECIFICATIONS

Length	20' (6 m)
Weight	0.567 lbs/ft (.844 kg/m)
Estimated Area	0.4727 in ² (3.05 cm ²)
Moment of Inertia	I _x =.0435 in ⁴ (1.81 cm ⁴) I _y =.0435 in ⁴ (1.81 cm ⁴)

12:02

TS25-50M [metric]

Item Number: **650026**

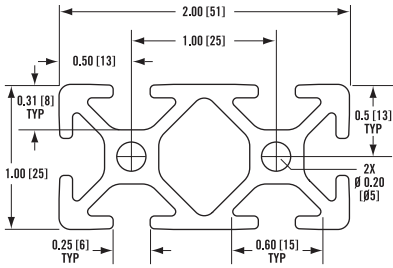

SPECIFICATIONS

Length	20' (6 m)
Weight	0.989 lbs/ft (1.472 kg/m)
Estimated Area	0.824 in ² (5.316 cm ²)
Moment of Inertia	I _x =.087 in ⁴ (3.621 cm ⁴)
	I _y =.321 in ⁴ (13.361 cm ⁴)

TS25-75M [metric]

Item Number: **650024**

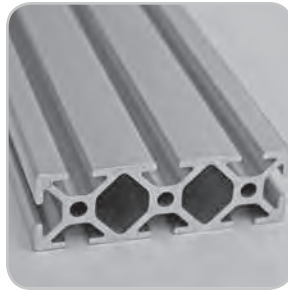
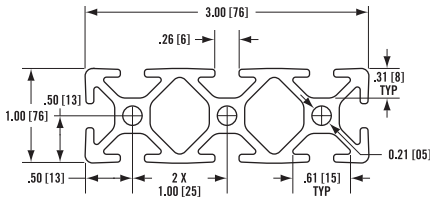

SPECIFICATIONS

Length	20' (6 m)
Weight	1.403 lbs/ft (2.087 kg/m)
Estimated Area	1.169 in ² (7.806 cm ²)
Moment of Inertia	I _x =.125 in ⁴ (5.202 cm ⁴)
	I _y =.986 in ⁴ (41.040 cm ⁴)

TS50-50M [metric]

Item Number: **650028**

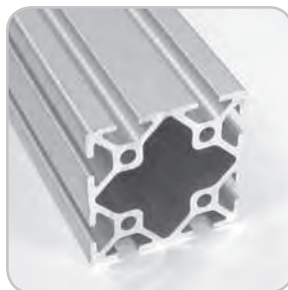
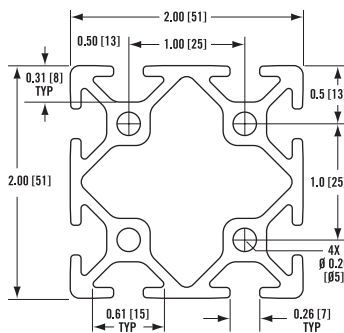

SPECIFICATIONS

Length	20' (6 m)
Weight	1.542 lbs/ft (2.295 kg/m)
Estimated Area	1.285 in ² (8.290 cm ²)
Moment of Inertia	I _x =.578 in ⁴ (24.058 cm ⁴)
	I _y =.578 in ⁴ (24.058 cm ⁴)

Metric

TS50-100M [metric]

Item Number: **650029**

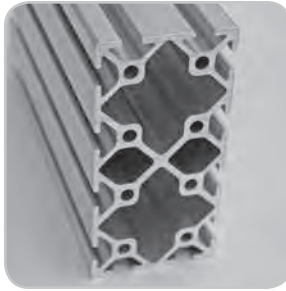
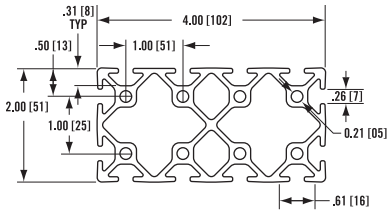

SPECIFICATIONS

Length	20' (6 m)
Weight	2.820 lbs/ft (4.195 kg/m)
Estimated Area	2.350 in ² (15.157 cm ²)
Moment of Inertia	I _x =1.075 in ⁴ (44.744 cm ⁴) I _y =3.656 in ⁴ (152.174 cm ⁴)

TS40-40M [metric]

Item Number: **650032**

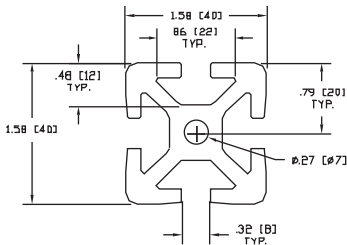

SPECIFICATIONS

Length	20' (6 m)
Weight	1.628 lbs/ft (2.423 kg/m)
Estimated Area	1.357 in ² (8.755 cm ²)
Moment of Inertia	I _x =.324 in ⁴ (13.486 cm ⁴) I _y =.324 in ⁴ (13.486 cm ⁴)

TS40-40LM [metric]

Item Number: **650033**

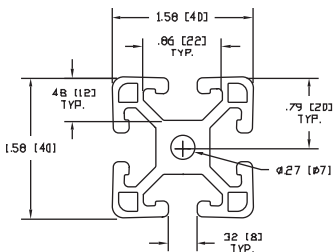

SPECIFICATIONS

Length	20' (6 m)
Weight	1.260 lbs/ft (1.875 kg/m)
Estimated Area	1.050 in ² (6.774 cm ²)
Moment of Inertia	I _x =.236 in ⁴ (9.823 cm ⁴) I _y =.236 in ⁴ (9.823 cm ⁴)

TS40-40VLM [metric]

Item Number: **650034**

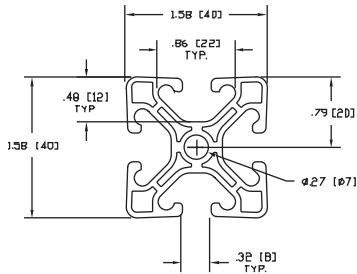

SPECIFICATIONS

Length	20' (6 m)
Weight	1.003 lbs/ft (1.445 kg/m)
Estimated Area	0.836 in ² (5.394 cm ²)
Moment of Inertia	I _x =.1972 in ⁴ (8.21 cm ⁴)
	I _y =.1972 in ⁴ (8.21 cm ⁴)

Extrusion Profiles available in stocked lengths. See Section 10 - Extrusion Profiles.

TS40-40LM BISLOT OPP [metric]

Item Number: **650051**

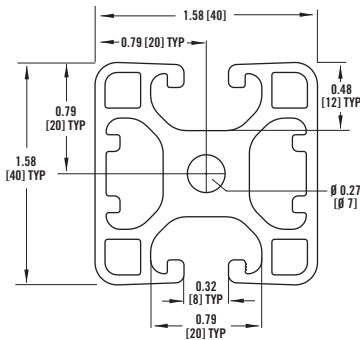

SPECIFICATIONS

Length	20' (6 m)
Weight	1.267 lbs/ft (1.886 kg/m)
Estimated Area	1.056 in ² (6.816 cm ²)
Moment of Inertia	I _x =0.214 in ⁴ (8.900 cm ⁴)
	I _y =0.250 in ⁴ (10.427 cm ⁴)

TS40-40LM BISLOT AD [metric]

Item Number: **650052**

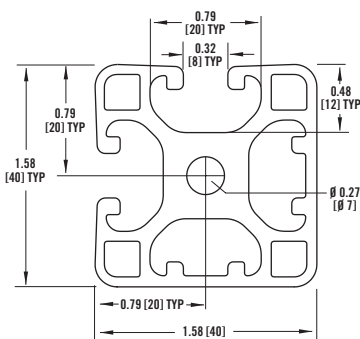

SPECIFICATIONS

Length	20' (6 m)
Weight	1.268 lbs/ft (1.887 kg/m)
Estimated Area	1.057 in ² (6.817 cm ²)
Moment of Inertia	I _x =0.214 in ⁴ (8.900 cm ⁴)
	I _y =0.231 in ⁴ (9.610 cm ⁴)

Metric

TS40-80M [metric]

Item Number: **650036**

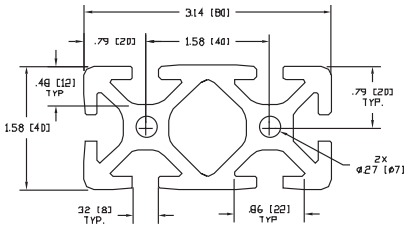

SPECIFICATIONS

Length	20' (6 m)
Weight	2.908 lbs/ft (4.329 kg/m)
Estimated Area	2.423 in ² (15.632 cm ²)
Moment of Inertia	I _x =.621 in ⁴ (25.848 cm ⁴) I _y =2.271 in ⁴ (94.526 cm ⁴)

TS40-80LM [metric]

Item Number: **650037**

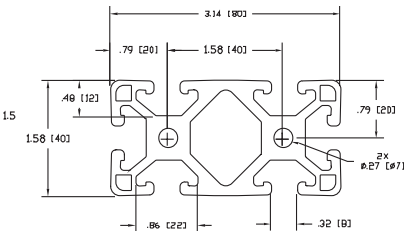

SPECIFICATIONS

Length	20' (6 m)
Weight	2.423 lbs/ft (3.609 kg/m)
Estimated Area	2.021 in ² (12.981 cm ²)
Moment of Inertia	I _x =.495 in ⁴ (20.603 cm ⁴) I _y =1.761 in ⁴ (73.298 cm ⁴)

TS40-80VLM [metric]

Item Number: **650038**

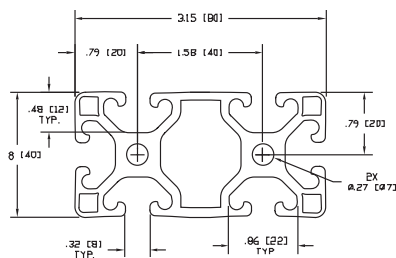

SPECIFICATIONS

Length	20' (6 m)
Weight	1.993 lbs/ft (2.966 kg/m)
Estimated Area	1.661 in ² (10.716 cm ²)
Moment of Inertia	I _x =.396 in ⁴ (16.48 cm ⁴) I _y =1.513 in ⁴ (62.98 cm ⁴)

TS80-80M [metric]

Item Number: **650039**

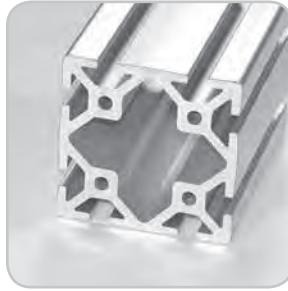
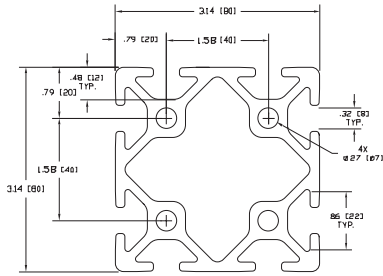

SPECIFICATIONS

Length	20' (6 m)
Weight	4.807 lbs/ft (7.154 kg/m)
Estimated Area	4.006 in ² (25.845 cm ²)
Moment of Inertia	I _x =4.289 in ⁴ (178.522 cm ⁴)
	I _y =4.289 in ⁴ (178.522 cm ⁴)

25 SERIES - 1/8" 2 Hole Inside Corner Bracket

Item Number: **653047**

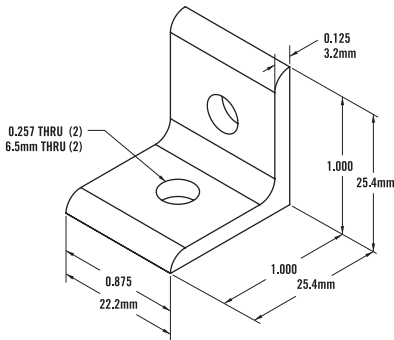

RECOMMENDED FASTENERS

QTY	DESCRIPTION	PART#
2	M6 x 10mm BHSCS & Economy T-Nut	651536

25 SERIES - 3/16" 2 Hole Inside Corner Bracket

Item Number: **653056**

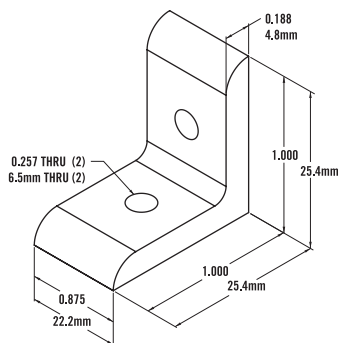

RECOMMENDED FASTENERS

QTY	DESCRIPTION	PART#
2	M6 x 12mm BHSCS & Economy T-Nut	651503

25 SERIES - 2 Hole Inside Corner Gusset

Item Number: **653069**

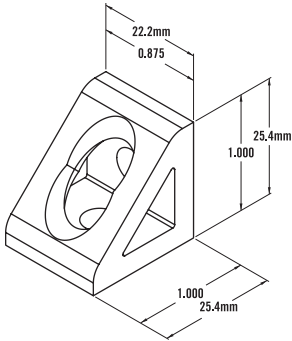

RECOMMENDED FASTENERS

QTY	DESCRIPTION	PART#
2	M6 x 12mm BHSCS & Economy T-Nut	651503

25 SERIES - 4 Hole Inside Corner Bracket

Item Number: **653052**

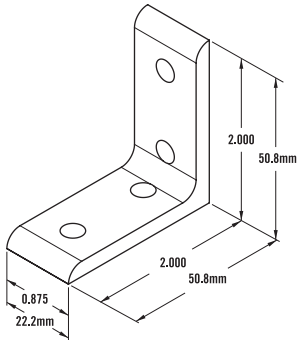

RECOMMENDED FASTENERS

QTY	DESCRIPTION	PART#
4	M6 x 12mm BHSCS & Economy T-Nut	651503
or 2	M6 x 12mm BHSCS & Double Economy T-Nut	651519

25 SERIES - 4 Hole Inside Corner Bracket

Item Number: **653045**

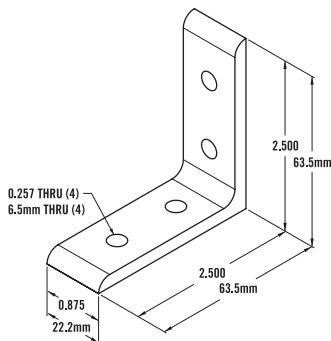

RECOMMENDED FASTENERS

QTY	DESCRIPTION	PART#
4	M6 x 12mm BHSCS & Economy T-Nut	651503
or 2	M6 x 12mm BHSCS & Double Economy T-Nut	651519

25 SERIES - 3 Hole Inside Corner Bracket

Item Number: **653107**

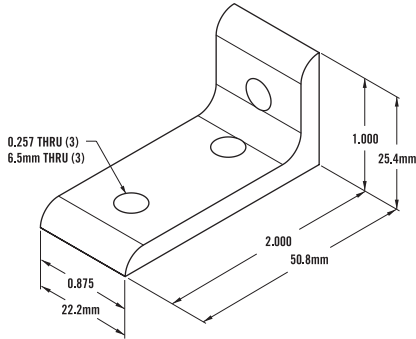

RECOMMENDED FASTENERS

QTY	DESCRIPTION	PART#
3	M6 x 12mm BHSCS & Economy T-Nut	651503
or 1	M6 x 12mm BHSCS & Double Economy T-Nut	651519
& 1	M6 x 12mm BHSCS & Economy T-Nut	651503

25 SERIES - 4 Hole Inside Corner Gusset

Item Number: **653073**

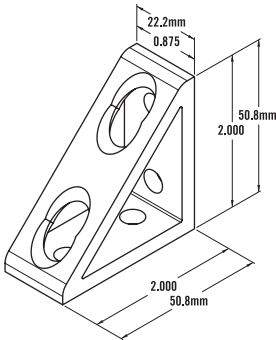

RECOMMENDED FASTENERS

QTY	DESCRIPTION	PART#
4	M6 x 12mm BHSCS & Economy T-Nut	651503
or 2	M6 x 12mm BHSCS & Double Economy T-Nut	651519

25 SERIES - 4 Hole Inside Corner Bracket

Item Number: **653050**

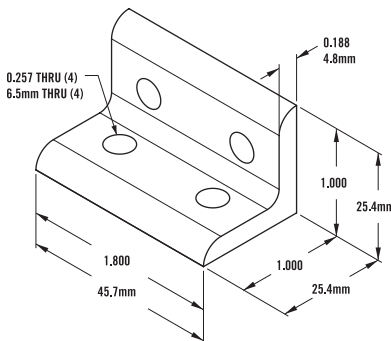

RECOMMENDED FASTENERS

QTY	DESCRIPTION	PART#
4	M6 x 12mm BHSCS & Economy T-Nut	651503
or 2	M6 x 12mm BHSCS & Double Economy T-Nut	651519

25 SERIES - 4 Hole Inside Corner Gusset

Item Number: **653071**

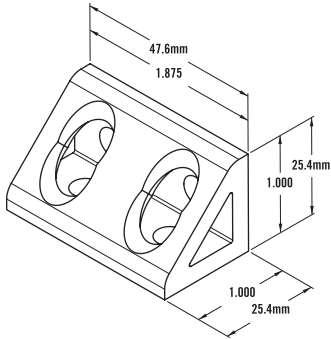

RECOMMENDED FASTENERS

QTY	DESCRIPTION	PART#
4	M6 x 12mm BHSCS & Economy T-Nut	651503
or 2	M6 x 12mm BHSCS & Double Economy T-Nut	651519

25 SERIES - 6 Hole Inside Corner Bracket

Item Number: **653106**

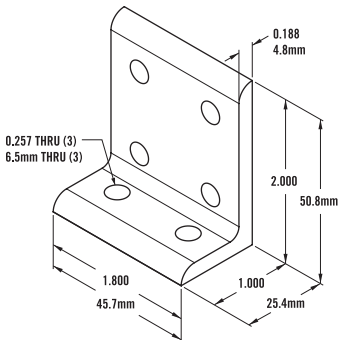

RECOMMENDED FASTENERS

QTY	DESCRIPTION	PART#
6	M6 x 12mm BHSCS & Economy T-Nut	651503
or 2	M6 x 12mm BHSCS & Double Economy T-Nut	651519
& 2	M6 x 12mm BHSCS & Economy T-Nut	651503

25 SERIES - 8 Hole Inside Corner Bracket

Item Number: **653051**

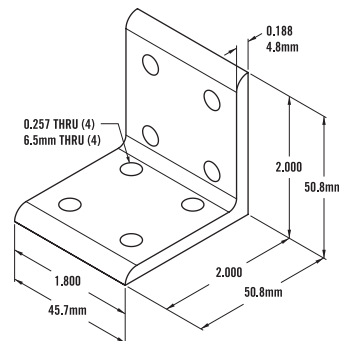

RECOMMENDED FASTENERS

QTY	DESCRIPTION	PART#
8	M6 x 12mm BHSCS & Economy T-Nut	651503
or 4	M6 x 12mm BHSCS & Double Economy T-Nut	651519

12:10

25 SERIES - 8 Hole Inside Corner Gusset

Item Number: **653075**

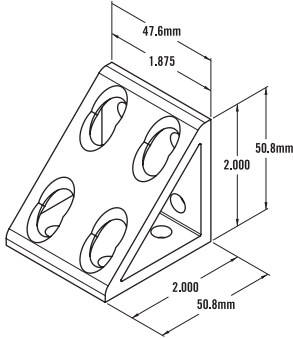

RECOMMENDED FASTENERS

QTY	DESCRIPTION	PART#
8	M6 x 12mm BHSCS & Economy T-Nut	651503
or 4	M6 x 12mm BHSCS & Double Economy T-Nut	651519

25 SERIES - 2 Hole Slotted Corner Bracket

Item Number: **653126**

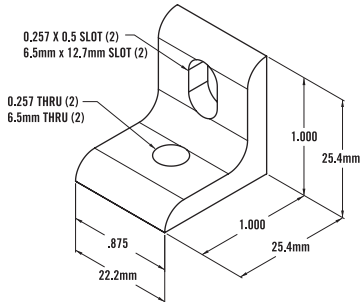

RECOMMENDED FASTENERS

QTY	DESCRIPTION	PART#
2	M6 x 12mm BHSCS & Economy T-Nut	651503

25 SERIES - 4 Hole Slotted Corner Bracket

Item Number: **653125**

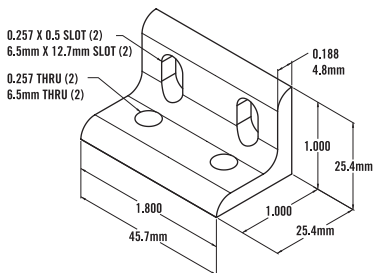

RECOMMENDED FASTENERS

QTY	DESCRIPTION	PART#
4	M6 x 12mm BHSCS & Economy T-Nut	651503

25 SERIES – 3 Hole Slotted Corner Bracket

Item Number: **653123**

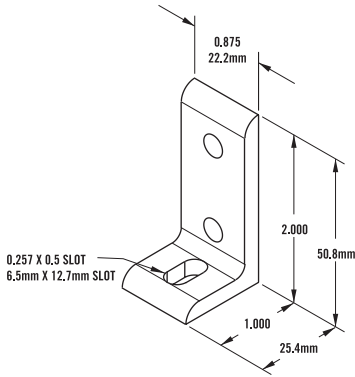

RECOMMENDED FASTENERS

QTY	DESCRIPTION	PART#
3	M6 x 12mm BHSCS & Economy T-Nut	651503
or 1	M6 x 12mm BHSCS & Double Economy T-Nut	651519
& 1	M6 x 12mm BHSCS & Economy T-Nut	651503

25 SERIES - 6 Hole Slotted Inside Corner Bracket

Item Number: **653131**

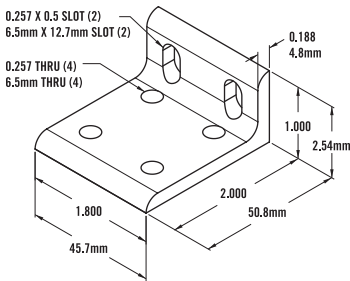

RECOMMENDED FASTENERS

QTY	DESCRIPTION	PART#
6	M6 x 12mm BHSCS & Economy T-Nut	651503
or 2	M6 x 12mm BHSCS & Double Economy T-Nut	651519
& 2	M6 x 12mm BHSCS & Economy T-Nut	651503

25 SERIES - 6 Hole Inside Corner Bracket

Item Number: **653012**

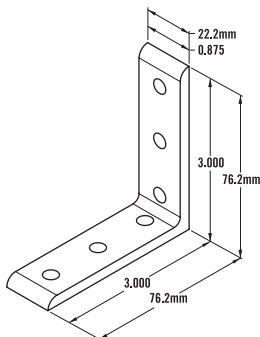

RECOMMENDED FASTENERS

QTY	DESCRIPTION	PART#
6	M6 x 12mm BHSCS & Economy T-Nut	651503
or 2	M6 x 12mm BHSCS & Double Economy T-Nut	651519
& 2	M6 x 12mm BHSCS & Economy T-Nut	651503

25 SERIES - 12 Hole Inside Corner Bracket

Item Number: **653013**

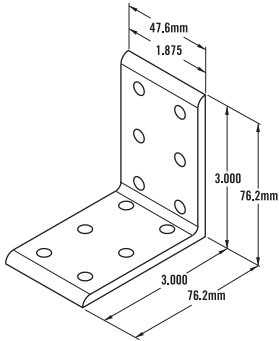

RECOMMENDED FASTENERS

QTY	DESCRIPTION	PART#
12	M6 x 12mm BHSCS & Economy T-Nut	651503
or 4	M6 x 12mm BHSCS & Double Economy T-Nut	651519
& 4	M6 x 12mm BHSCS & Economy T-Nut	651503

25 SERIES - 6 Hole Inside Corner Bracket

Item Number: **653014**

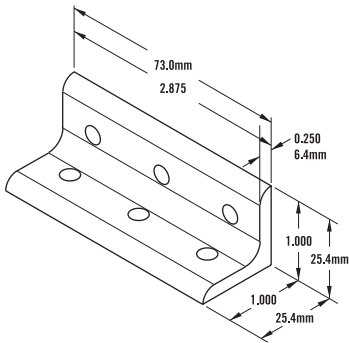

RECOMMENDED FASTENERS

QTY	DESCRIPTION	PART#
2	M6 x 12mm BHSCS & Economy T-Nut	651503

25 SERIES - 6 Hole Slotted Corner Bracket

Item Number: **653127**

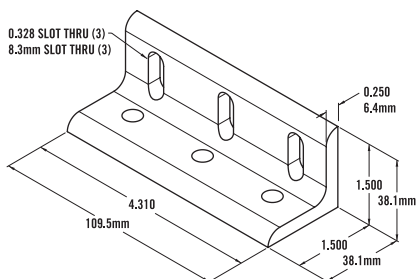

RECOMMENDED FASTENERS

QTY	DESCRIPTION	PART#
6	M6 x 12mm BHSCS & Economy T-Nut	651503

25 SERIES – 9 Hole Slotted Corner Bracket

Item Number: **653124**

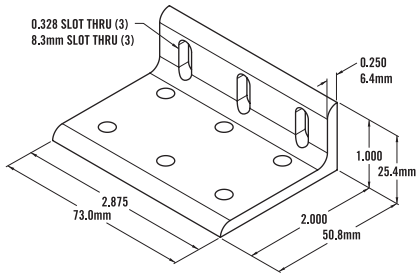

RECOMMENDED FASTENERS

QTY	DESCRIPTION	PART#
9	M6 x 12mm BHSCS & Economy T-Nut	651503
or 3	M6 x 12mm BHSCS & Double Economy T-Nut	651519
& 3	M6 x 12mm BHSCS & Economy T-Nut	651503

25 SERIES - 12 Hole Inside Corner Bracket

Item Number: **653015**

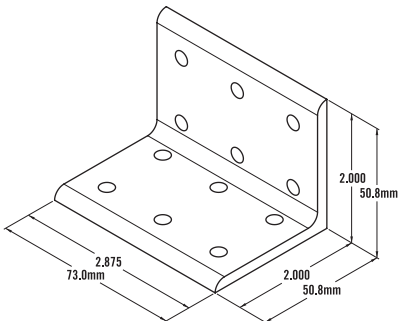

RECOMMENDED FASTENERS

QTY	DESCRIPTION	PART#
12	M6 x 12mm BHSCS & Economy T-Nut	651503
or 6	M6 x 12mm BHSCS & Double Economy T-Nut	651519

25 SERIES - 18 Hole Inside Corner Bracket

Item Number: **653016**

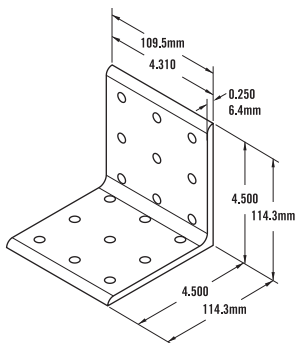

RECOMMENDED FASTENERS

QTY	DESCRIPTION	PART#
18	M6 x 12mm BHSCS & Economy T-Nut	651503

25 SERIES - 2 Hole Inside Corner Bracket

Item Number: **653046**

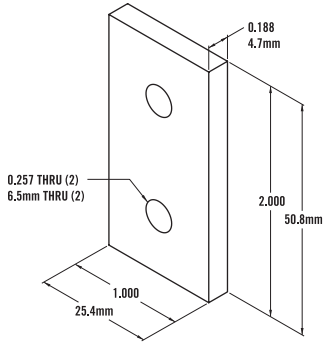

RECOMMENDED FASTENERS

QTY	DESCRIPTION	PART#
2	M6 x 12mm BHSCS & Economy T-Nut	651503
or 1	M6 x 12mm BHSCS & Double Economy T-Nut	651519

25 SERIES - 3 Hole Joining Strip

Item Number: **653055**

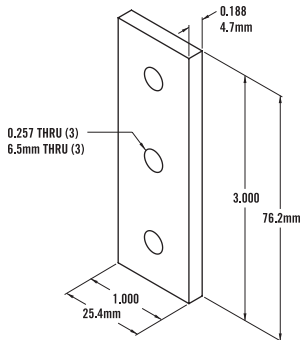

RECOMMENDED FASTENERS

QTY	DESCRIPTION	PART#
3	M6 x 12mm BHSCS & Economy T-Nut	651503
or 1	M6 x 12mm BHSCS & Double Economy T-Nut	651519
& 1	M6 x 12mm BHSCS & Economy T-Nut	651503

25 SERIES - 4 Hole Joining Strip

Item Number: **653054**

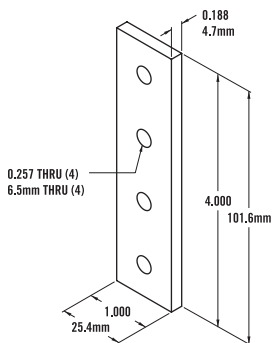

RECOMMENDED FASTENERS

QTY	DESCRIPTION	PART#
4	M6 x 12mm BHSCS & Economy T-Nut	651503
or 2	M6 x 12mm BHSCS & Double Economy T-Nut	651519

25 SERIES – 4 Hole Joining Plate

Item Number: **653100**

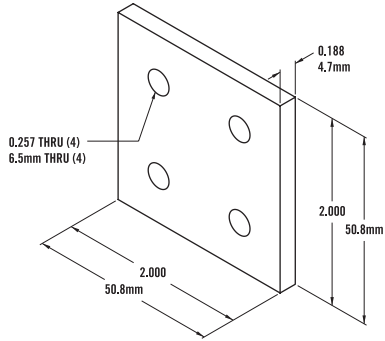

RECOMMENDED FASTENERS

QTY	DESCRIPTION	PART#
4	M6 x 12mm BHSCS & Economy T-Nut	651503
or 2	M6 x 12mm BHSCS & Double Economy T-Nut	651519

25 SERIES - 6 Hole Joining Plate

Item Number: **653099**

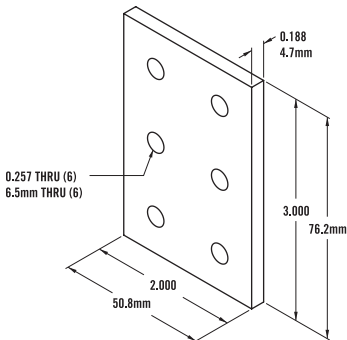

RECOMMENDED FASTENERS

QTY	DESCRIPTION	PART#
6	M6 x 12mm BHSCS & Economy T-Nut	651503

25 SERIES - 8 Hole Joining Plate

Item Number: **653098**

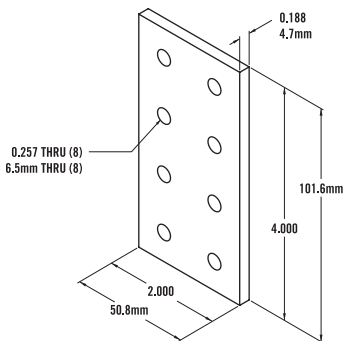

RECOMMENDED FASTENERS

QTY	DESCRIPTION	PART#
8	M6 x 12mm BHSCS & Economy T-Nut	651503
or 4	M6 x 12mm BHSCS & Double Economy T-Nut	651519

25 SERIES - 4 Hole 90° Joining Plate

Item Number: **653084**

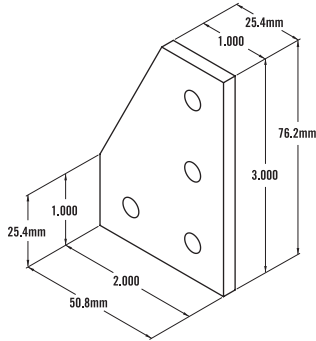

RECOMMENDED FASTENERS

QTY	DESCRIPTION	PART#
4	M6 x 12mm BHSCS & Economy T-Nut	651503
or 2	M6 x 12mm BHSCS & Double Economy T-Nut	651519

25 SERIES - 5 Hole 90° Joining Plate

Item Number: **653085**

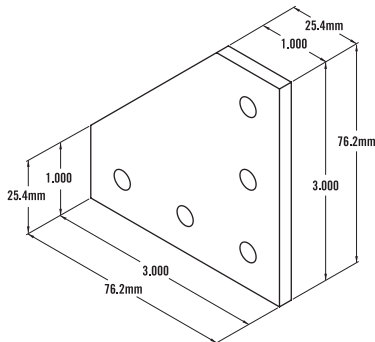

RECOMMENDED FASTENERS

QTY	DESCRIPTION	PART#
5	M6 x 12mm BHSCS & Economy T-Nut	651503
or 2	M6 x 12mm BHSCS & Double Economy T-Nut	651519
& 1	M6 x 12mm BHSCS & Economy T-Nut	651503

25 SERIES - 7 Hole 90° Joining Plate

Item Number: **653086**

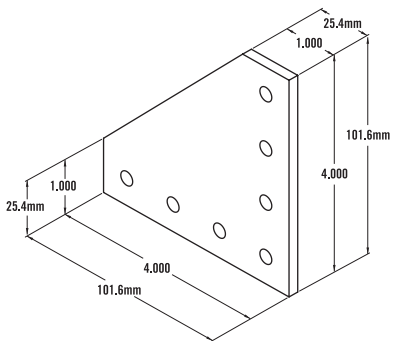

RECOMMENDED FASTENERS

QTY	DESCRIPTION	PART#
7	M6 x 12mm BHSCS & Economy T-Nut	651503
or 3	M6 x 12mm BHSCS & Double Economy T-Nut	651519
& 1	M6 x 12mm BHSCS & Economy T-Nut	651503

25 SERIES – 6 Hole 90° Joining Plate

Item Number: **653057**

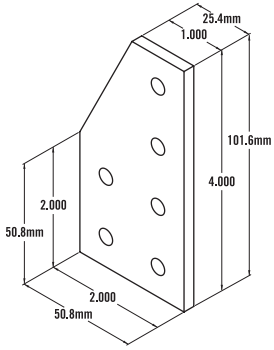

RECOMMENDED FASTENERS

QTY	DESCRIPTION	PART#
6	M6 x 12mm BHSCS & Economy T-Nut	651503
or 3	M6 x 12mm BHSCS & Double Economy T-Nut	651519

25 SERIES - 7 Hole 90° Joining Plate

Item Number: **653066**

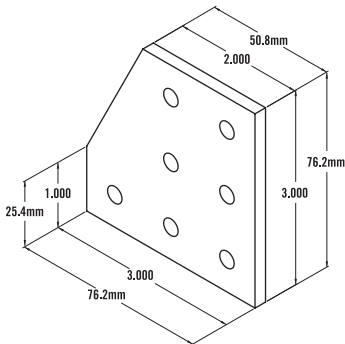

RECOMMENDED FASTENERS

QTY	DESCRIPTION	PART#
7	M6 x 12mm BHSCS & Economy T-Nut	651503
or 3	M6 x 12mm BHSCS & Double Economy T-Nut	651519
& 1	M6 x 12mm BHSCS & Economy T-Nut	651503

25 SERIES - 10 Hole 90° Joining Plate

Item Number: **653064**

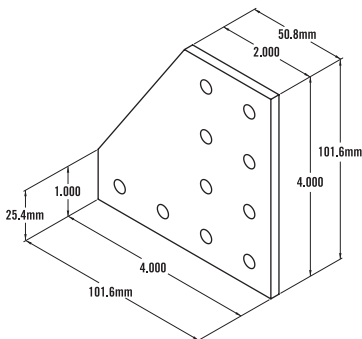

RECOMMENDED FASTENERS

QTY	DESCRIPTION	PART#
10	M6 x 12mm BHSCS & Economy T-Nut	651503

25 SERIES - 12 Hole 90° Joining Plate

Item Number: **653065**

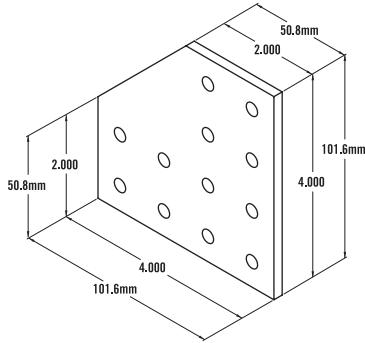

RECOMMENDED FASTENERS

QTY	DESCRIPTION	PART#
12	M6 x 12mm BHSCS & Economy T-Nut	651503
or 6	M6 x 12mm BHSCS & Double Economy T-Nut	651519

25 SERIES - 4 Hole Joining Plate

Item Number: **653078**

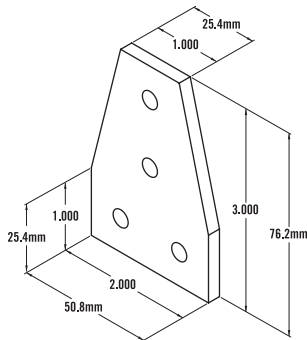

RECOMMENDED FASTENERS

QTY	DESCRIPTION	PART#
4	M6 x 12mm BHSCS & Economy T-Nut	651503
or 2	M6 x 12mm BHSCS & Double Economy T-Nut	651519

25 SERIES - 5 Hole Tee Joining Plate

Item Number: **653077**

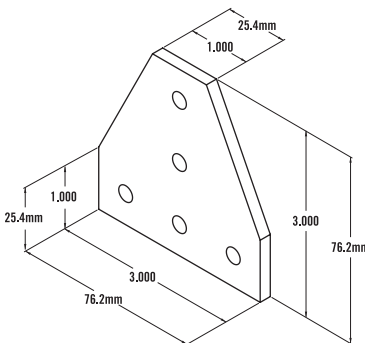

RECOMMENDED FASTENERS

QTY	DESCRIPTION	PART#
5	M6 x 12mm BHSCS & Economy T-Nut	651503
or 2	M6 x 12mm BHSCS & Double Economy T-Nut	651519
& 1	M6 x 12mm BHSCS & Economy T-Nut	651503

25 SERIES – 7 Hole Tee Joining Plate

Item Number: **653049**

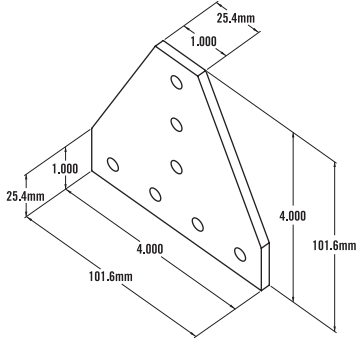

RECOMMENDED FASTENERS

QTY	DESCRIPTION	PART#
7	M6 x 12mm BHSCS & Economy T-Nut	651503
or 3	M6 x 12mm BHSCS & Double Economy T-Nut	651519
& 1	M6 x 12mm BHSCS & Economy T-Nut	651503

25 SERIES - 8 Hole Tee Joining Plate

Item Number: **653089**

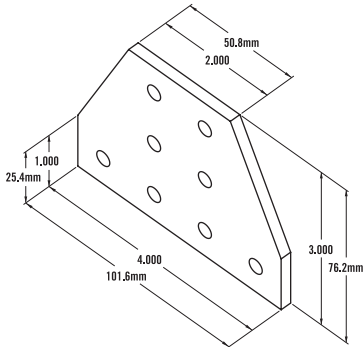

RECOMMENDED FASTENERS

QTY	DESCRIPTION	PART#
8	M6 x 12mm BHSCS & Economy T-Nut	651503
or 4	M6 x 12mm BHSCS & Double Economy T-Nut	651519

25 SERIES - 12 Hole Tee Joining Plate

Item Number: **653062**

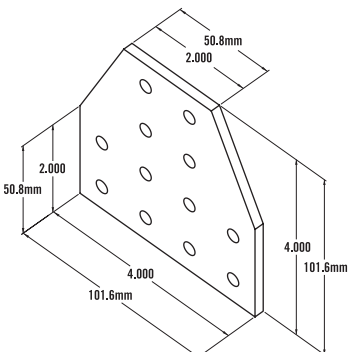

RECOMMENDED FASTENERS

QTY	DESCRIPTION	PART#
12	M6 x 12mm BHSCS & Economy T-Nut	651503
or 6	M6 x 12mm BHSCS & Double Economy T-Nut	651519

25 SERIES - 7 Hole Crossing Joining Plate

Item Number: **653072**

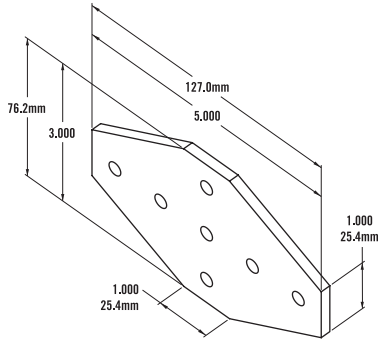

RECOMMENDED FASTENERS

QTY	DESCRIPTION	PART#
7	M6 x 12mm BHSCS & Economy T-Nut	651503
or 3	M6 x 12mm BHSCS & Double Economy T-Nut	651519
or 1	M6 x 12mm BHSCS & Economy T-Nut	651503

25 SERIES - 12 Hole Crossing Joining Plate

Item Number: **653094**

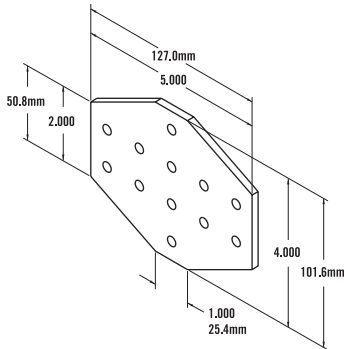

RECOMMENDED FASTENERS

QTY	DESCRIPTION	PART#
12	M6 x 12mm BHSCS & Economy T-Nut	651503
or 6	M6 x 12mm BHSCS & Double Economy T-Nut	651519

25 SERIES - 16 Hole Crossing Joining Plate

Item Number: **653103**

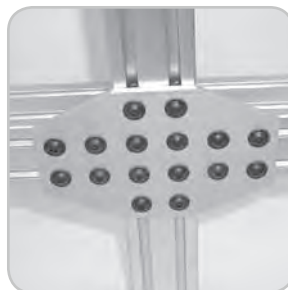
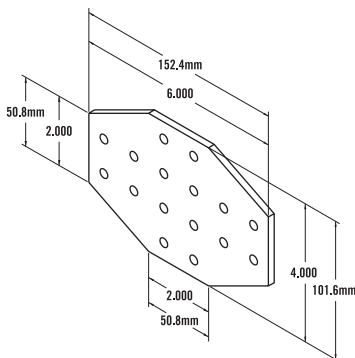

RECOMMENDED FASTENERS

QTY	DESCRIPTION	PART#
16	M6 x 12mm BHSCS & Economy T-Nut	651503
or 8	M6 x 12mm BHSCS & Double Economy T-Nut	651519

40 SERIES - 2 Hole Slotted Inside Corner Bracket

Item Number: **664003**

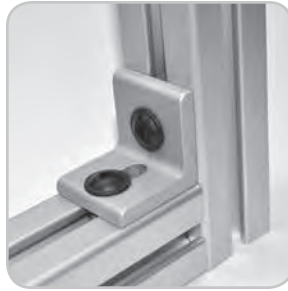
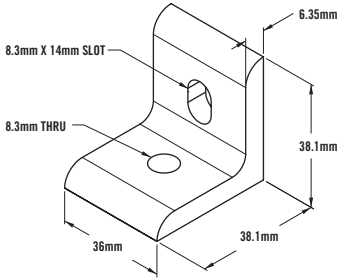

RECOMMENDED FASTENERS

QTY	DESCRIPTION	PART#
2	M8 x 16mm BHSCS & Economy T-Nut	651506

40 SERIES – 2 Hole Inside Corner Bracket

Item Number: **664005**

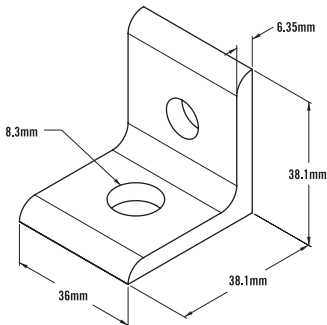

RECOMMENDED FASTENERS

QTY	DESCRIPTION	PART#
2	M8 x 16mm BHSCS & Economy T-Nut	651506

40 SERIES - 2 Hole Inside Corner Gusset

Item Number: **664006**

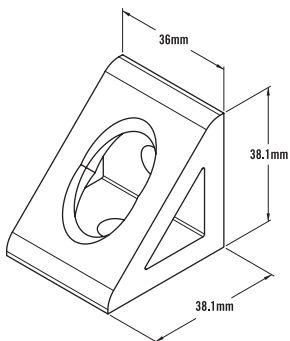

RECOMMENDED FASTENERS

QTY	DESCRIPTION	PART#
2	M8 x 16mm BHSCS & Economy T-Nut	651506

40 SERIES - 3 Hole Inside Corner Bracket

Item Number: **664007**

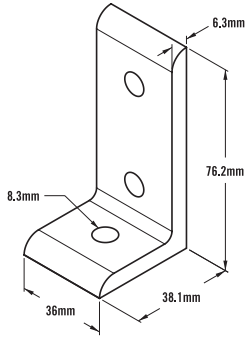

RECOMMENDED FASTENERS

QTY	DESCRIPTION	PART#
3	M8 x 16mm BHSCS & Economy T-Nut	651506
or 1	M8 x 16mm BHSCS & Economy T-Nut	651506
& 1	M8 x 16mm BHSCS & Double Economy T-Nut	651521

40 SERIES - 4 Hole Inside Corner Bracket

Item Number: **664004**

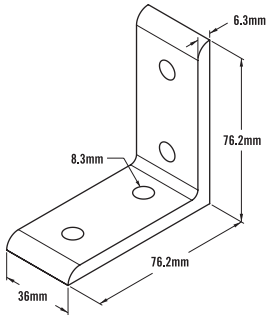

RECOMMENDED FASTENERS

QTY	DESCRIPTION	PART#
4	M8 x 16mm BHSCS & Economy T-Nut	651506
or 2	M8 x 16mm BHSCS & Double Economy T-Nut	651521

40 SERIES - 4 Hole Inside Corner Bracket

Item Number: **664001**

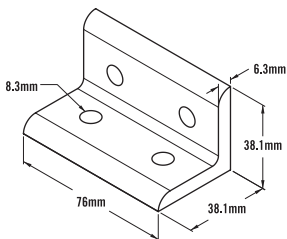

RECOMMENDED FASTENERS

QTY	DESCRIPTION	PART#
4	M8 x 16mm BHSCS & Economy T-Nut	651506

40 SERIES - 4 Hole Slotted Inside Corner Bracket

Item Number: **659060**

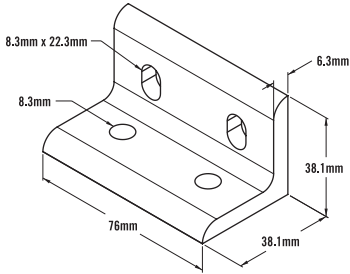

RECOMMENDED FASTENERS

QTY	DESCRIPTION	PART#
4	M8 x 16mm BHSCS & Economy T-Nut	651506

40 SERIES - 4 Hole Inside Corner Gusset

Item Number: **664032**

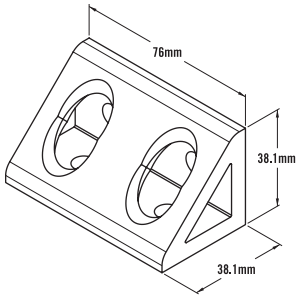

RECOMMENDED FASTENERS

QTY	DESCRIPTION	PART#
4	M8 x 16mm BHSCS & Economy T-Nut	651506

40 SERIES - 4 Hole Inside Corner Gusset

Item Number: **664002**

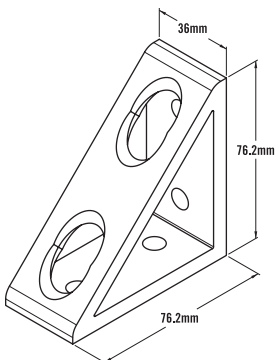

RECOMMENDED FASTENERS

QTY	DESCRIPTION	PART#
4	M8 x 16mm BHSCS & Economy T-Nut	651506
or 2	M8 x 16mm BHSCS & Double Economy T-Nut	651521

40 SERIES - 8 Hole Inside Corner Bracket

Item Number: **664027**

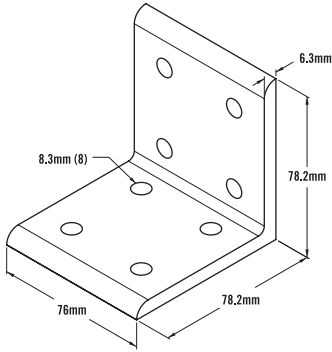

RECOMMENDED FASTENERS

QTY	DESCRIPTION	PART#
8	M8 x 16mm BHSCS & Economy T-Nut	651506
or 4	M8 x 16mm BHSCS & Double Economy T-Nut	651521

40 SERIES - 8 Hole Inside Corner Gusset

Item Number: **664000**

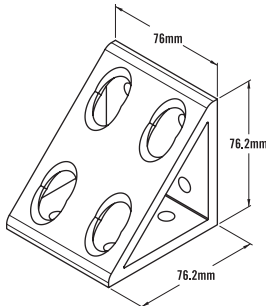

RECOMMENDED FASTENERS

QTY	DESCRIPTION	PART#
8	M8 x 16mm BHSCS & Economy T-Nut	651506
or 4	M8 x 16mm BHSCS & Double Economy T-Nut	651521

40 SERIES - 4 Hole Joining Plate

Item Number: **664049**

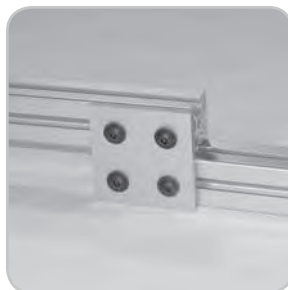
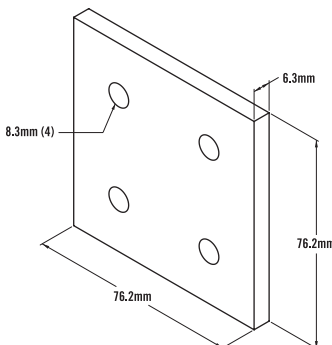

RECOMMENDED FASTENERS

QTY	DESCRIPTION	PART#
4	M8 x 16mm BHSCS & Economy T-Nut	651506
or 2	M8 x 16mm BHSCS & Double Economy T-Nut	651521

40 SERIES - 8 Hole Joining Plate

Item Number: **659059**

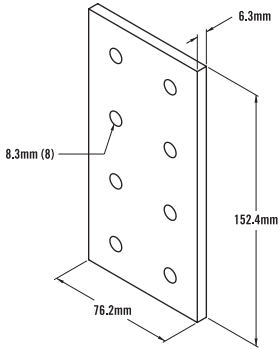

RECOMMENDED FASTENERS

QTY	DESCRIPTION	PART#
8	M8 x 16mm BHSCS & Economy T-Nut	651506
or 4	M8 x 16mm BHSCS & Double Economy T-Nut	651521

40 SERIES - 3 Hole Joining Strip

Item Number: **664041**

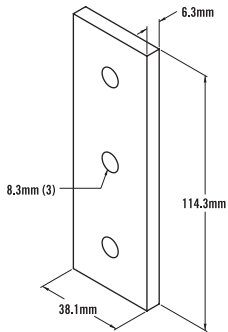

RECOMMENDED FASTENERS

QTY	DESCRIPTION	PART#
3	M8 x 16mm BHSCS & Economy T-Nut	651506

40 SERIES - 2 Hole Joining Strip

Item Number: **664057**

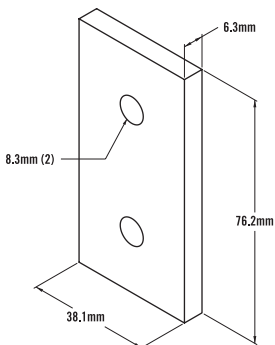

RECOMMENDED FASTENERS

QTY	DESCRIPTION	PART#
2	M8 x 16mm BHSCS & Economy T-Nut	651506

40 SERIES - 4 Hole Joining Strip

Item Number: **664050**

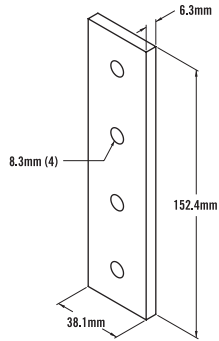

RECOMMENDED FASTENERS

QTY	DESCRIPTION	PART#
4	M8 x 16mm BHSCS & Economy T-Nut	651506

40 SERIES - 5 Hole Tee Joining Plate

Item Number: **664051**

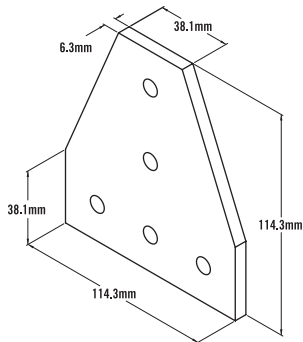

RECOMMENDED FASTENERS

QTY	DESCRIPTION	PART#
5	M8 x 16mm BHSCS & Economy T-Nut	651506

40 SERIES - 5 Hole 90° Joining Plate

Item Number: **664029**

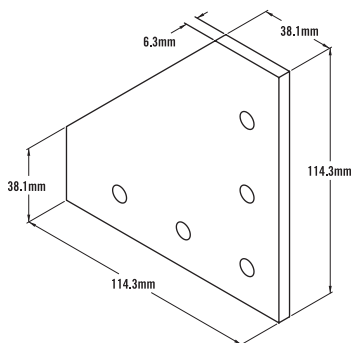

RECOMMENDED FASTENERS

QTY	DESCRIPTION	PART#
5	M8 x 16mm BHSCS & Economy T-Nut	651506
or 2	M8 x 16mm BHSCS & Double Economy T-Nut	651521
& 1	M8 x 16mm BHSCS & Economy T-Nut	651506

40 SERIES - 12 Hole 90° Joining Plate

Item Number: **664053**

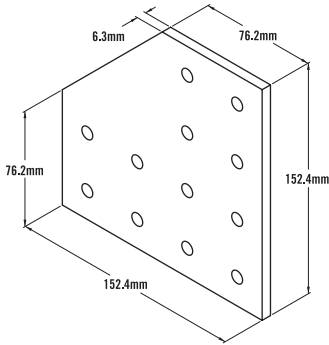

RECOMMENDED FASTENERS

QTY	DESCRIPTION	PART#
12	M8 x 16mm BHSCS & Economy T-Nut	651506
or 6	M8 x 16mm BHSCS & Double Economy T-Nut	651521

40 SERIES - 12 Hole Tee Joining Plate

Item Number: **664054**

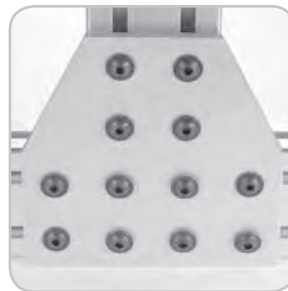
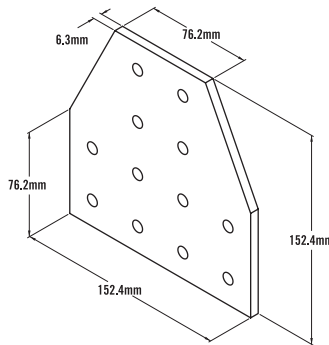

RECOMMENDED FASTENERS

QTY	DESCRIPTION	PART#
12	M8 x 16mm BHSCS & Economy T-Nut	651506
or 6	M8 x 16mm BHSCS & Double Economy T-Nut	651521

FASTENER/TOOL RECOMMENDED CHART

THREAD SIZE	FASTENER HEAD			
	SHCS	BHSCS	FBHSCS	FHSCS
8/32	n/a	3/32"	n/a	n/a
10-32	5/32"	1/8"	n/a	n/a
1/4-20	3/16"	5/32"	5/32"	5/32"
5/16-18	1/4"	3/16"	3/16"	3/16"
3/8-16	5/16"	n/a	n/a	7/32"
M6	5mm	4mm	n/a	n/a
M8	6mm	5mm	n/a	n/a

* Numbers in chart reflect hex tool size required.

ECONOMY T-NUTS



ITEM #	DESCRIPTION	THREAD
651386	Bright Zinc 10 S / 25 S Metric Economy T-Nut offset	M6x1.0
651366	Bright Zinc 15 S / 40 S Metric Economy T-Nut offset	M6x1.0
651367	Bright Zinc 15 S / 40 S Metric Economy T-Nut offset	M8x1.25
651445	Black Zinc 15 S / 40 S Metric Economy T-Nut	M8x1.25

- Economical
- High Strength
- Extrusion end loading only
- 25 & 40 Series sizes

DOUBLE ECONOMY T-NUTS



- Economical
- High Strength
- Extrusion end loading only
- 25 & 40 Series sizes
- More convenient and better productivity over single economy T-Nut
- 25mm and 40mm centerlines make pre-assembly easy

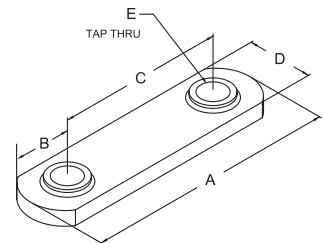

ITEM #	DESCRIPTION	THREAD	A	B	C	D	E
651331	Bright Zinc 10 S / 25 S Metric Dbl. Economy T-Nut	M6x1.0	1.87	0.443	1	0.443	M6x1.0
651461	Black Zinc 40 S Double Economy T-Nut	M8x1.25	76mm	19mm	40mm	16mm	M8x1.25

STANDARD T-NUTS OFFSET



ITEM #	DESCRIPTION	THREAD
651398	Bright Zinc 10 S / 25 S Standard T-Nut	M5x.8
651400	Bright Zinc 10 S / 25 S Standard T-Nut	M6x1.0
651393	Bright Zinc 15 S / 40 S Standard T-Nut	M6x1.0
651395	Bright Zinc 15 S / 40 S Standard T-Nut	M8x1.25
651477	10 S / 25 S Standard T-Nut Profile	36" length
651475	15 S / 40 S Standard T-Nut Profile	36" length

- 25 and 40 Series sizes
- Extrusion end loading only
- High Strength
- Economical

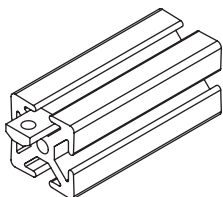

DROP IN T-NUTS WITH RUBBER HANDLE

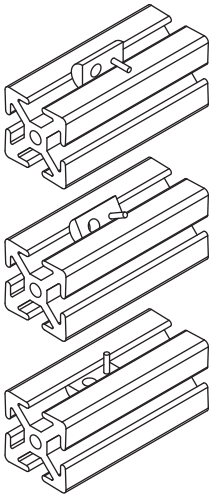

ITEM #	DESCRIPTION	THREAD
651402	Bright Zinc 10 S / 25 S Drop In T-Nut	M5x.8
651403	Bright Zinc 10 S / 25 S Drop In T-Nut	M6x1.0
651372	Bright Zinc 15 S / 40 S Drop In T-Nut	M6x1.0
651371	Bright Zinc 15 S / 40 S Drop In T-Nut	M8x1.25

- Tapered bottom allows for easy loading and removal from extrusion slot
- Reduces assembly time
- Easy to add and reposition in T-Slot when ends are closed off
- Rubber nub holds T-Nut in vertical T-Slot
- 25 and 40 Series sizes
- High Strength

DROP IN T-NUTS WITH SET SCREW



ITEM #	DESCRIPTION	THREAD
651421	Bright Zinc 15 S / 40 S Drop In T-Nut w/ Set Screw	M8x1.25
651425	Bright Zinc 15 S / 40 S Drop In T-Nut w/ Set Screw	M6x1.0

- Tapered bottom allows for easy loading and removal from extrusion slot
- Reduces assembly time
- Easy to add and reposition in T-Slot when ends are closed off
- Set screw holds T-Nut in vertical T-Slot
- 40 Series sizes
- High Strength

DROP IN T-NUTS WITH BALL BEARING



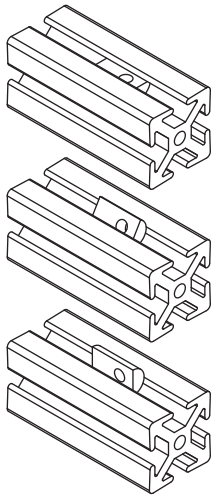

ITEM #	DESCRIPTION	THREAD
651471	10 S / 25 S Bright Zinc Drop-in Tnut w/ Ball Bearing	M5 x.8
651472	10 S / 25 S Bright Zinc Drop-in Tnut w/ Ball Bearing	M6 x1.0
651646	15 S / 40 S Bright Zinc Drop-in Tnut w/ Ball Bearing	M5 x.8
651647	15 S / 40 S Bright Zinc Drop-in Tnut w/ Ball Bearing	M6 x1.0
651648	15 S / 40 S Bright Zinc Drop-in Tnut w/ Ball Bearing	M8 x1.25

- Tapered bottom allows for easy loading and removal from extrusion slot
- Reduces assembly time
- Easy to add and reposition in T-Slot when ends are closed off
- Ball bearing holds T-Nut in vertical T-Slot
- 25 and 40 Series sizes
- High Strength



STEPPED DROP IN T-NUTS WITH BALL BEARING



ITEM #	DESCRIPTION	THREAD
664111	15 S Stepped Drop In T-Nut w/ Ball Bearing	M5 
664112	15 S Stepped Drop In T-Nut w/ Ball Bearing	M6 
664113	15 S Stepped Drop In T-Nut w/ Ball Bearing	M8 

- Self aligning roll-in T-SLOT nut with spring ball, zinc plated steel

Metric

Z-NUTS



ITEM #	DESCRIPTION	THREAD
662002	M5 Z-Nut	M5
662001	M6 Z-Nut	M6

- Design allows for easy loading from extrusion slot
- Fits 40 Series sizes
- Metric thread size only

BUTT FASTENERS



ITEM #	DESCRIPTION
651153	10 S / 25 S Butt Fastener
651154	15 S / 40 S Butt Fastener

- Allows you to butt two extrusions end to end for maximum strength and alignment
- 25 and 40 Series sizes

» See page 11:08 for machining services.

ANCHOR FASTENERS



ITEM #	DESCRIPTION
651500	10 S / 25 S Anchor Fastener w/M5 Bolt & Std. T-Nut
651424	15 S / 40 S Metric Anchor Fastener w/ M8 Bolt & Std. T-Nut

- Strongest of available fasteners
- Creates 90 degree T-Slot connections
- 25 & 40 Series sizes
- All T-Nuts are offset

END FASTENERS



ITEM #	DESCRIPTION	THREAD
651422	Bright Zinc 10 S / 25 S End Fastener with Screw	M6x1.0
651291	Bright Zinc 10 S / 25 S End Fastener without Screw	n/a
651159	Black Zinc 10 S / 25 S End Fastener without Screw	n/a
651418	Bright Zinc 15 S / 40 S End Fastener with Screw	M8x1.25
651289	Bright Zinc 15 S / 40 S End Fastener without Screw	n/a
651160	Black Zinc 15 S / 40 S End Fastener without Screw	n/a

- Provides a hidden fastener when connecting extrusions at 90 degrees
- Mating extrusions glide over end fastener
- Tapping service required in the extrusion base end and access hole in the mating extrusion
- 25 and 40 Series sizes
- Prevents mating extrusion from rotating

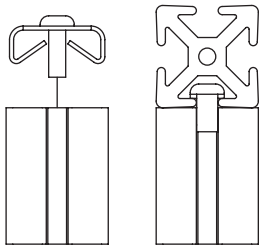

DOUBLE END FASTENERS



ITEM #	DESCRIPTION	THREAD
651428	Bright Zinc 10 S / 25 S Metric Double End Fastener with Screw	M6x1.0
651329	Bright Zinc 10 S / 25 S Double End Fastener without Screw	n/a
651139	Black Zinc 10 S / 25 S Double End Fastener without Screw	n/a

- Provides a hidden fastener when connecting extrusions at 90 degrees
- Mating extrusions glide over end fastener
- Tapping service required in the extrusion base end and access hole in the mating extrusion
- 10 and 25 Series sizes only
- Prevents mating extrusion from rotating

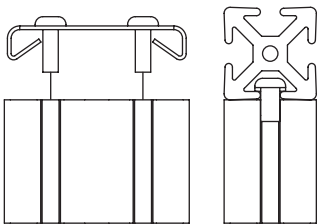

SINGLE TAB END FASTENER



ITEM #	DESCRIPTION
651495	15 S / 40 S Single Tab End Fastener w/o Screw
651502	40 S Single Tab End Fastener w/ M8 x 20 mm BHSCS

- Allows for panels to mate in slots without having to notch panels
- Provides hidden fastener when connecting extrusions at 90°
- Mating extrusions glide over end fastener
- Tapping service required in the extrusion base end and access hole in the mating extrusions
- 40 Series sizes only

PUSH IN FASTENERS



ITEM #	DESCRIPTION
651084	10 S / 25 S Push In Fastener
651090	10 S / 40 S Push In Fastener

- Pushes into center holes of 25 and 40 Series extrusions
- Used to fasten End Caps onto extrusions

BUTTON HEAD SOCKET CAP SCREW & ASSEMBLIES

ITEM #	DESCRIPTION
651333	M6 x 12 mm BHSCS
651335	M6 x 16 mm BHSCS
651340	M6 x 20 mm BHSCS
651661	M6 x 20 mm BHSCS Bright Zinc
651341	M6 x 25 mm BHSCS
651343	M8 x 12 mm BHSCS
651345	M8 x 16 mm BHSCS
651347	M8 x 20 mm BHSCS
651351	M8 x 25 mm BHSCS

25 SERIES ASSEMBLIES

ITEM #	DESCRIPTION
651536	M6 x 10 mm BHSCS & Economy T-Nut
651503	M6 x 12 mm BHSCS & Economy T-Nut
651519	M6 x 12 mm BHSCS & Double Economy T-Nut

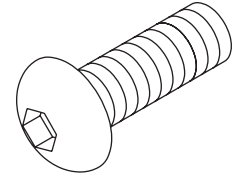

40 SERIES ASSEMBLIES

ITEM #	DESCRIPTION
651506	M8 x 16 mm BHSCS & Economy T-Nut
651521	M8 x 16 mm BHSCS & Double Economy T-Nut

» See page 01:02 for torque specifications.

SOCKET HEAD CAP SCREWS & ASSEMBLIES

ITEM #	DESCRIPTION
699933	M5 x 16 mm SHCS
651332	M6 x 12 mm SHCS
651334	M6 x 16 mm SHCS
651337	M6 x 20 mm SHCS
651338	M6 x 25 mm SHCS
658592	M6 x 35 mm SHCS
651342	M8 x 12 mm SHCS
651344	M8 x 16 mm SHCS
651346	M8 x 20 mm SHCS
651350	M8 x 25 mm SHCS
651354	M8 x 30 mm SHCS
651542	M8 x 40 mm SHCS

25 SERIES ASSEMBLIES

ITEM #	DESCRIPTION
651509	M6 x 12 mm SHCS & Economy T-N

40 SERIES ASSEMBLIES

ITEM #	DESCRIPTION
651512	M8 x 16 mm SHCS & Economy T-Nut

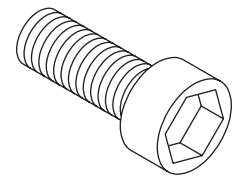

» See page 01:02 for torque specifications.

FLATHEAD SOCKET CAP SCREW & ASSEMBLIES

ITEM #	DESCRIPTION
651515	M6 x 12 mm FHSCS
651516	M6 x 16 mm FHSCS
651517	M8 x 16 mm FHSCS
651518	M8 x 20 mm FHSCS

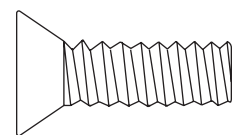

THREADED STEM SWIVEL CASTERS



ITEM #	DESCRIPTION
651522	35mm Swivel Caster w/ M10 x 30 Stem w/o Brake
651523	50mm Swivel Caster w/ M10 x 30 Stem w/ Brake
651524	75mm Swivel Caster w/ M10 x 30 Stem w/ Brake
651525	100mm Swivel Caster w/ M10 x 30 Stem w/ Brake
651526	125mm Swivel Caster w/ M10 x 30 Stem w/ Brake

- Mounts directly to extrusion end or base plates
- 70-150 lb. Capacity
- 25 and 40 Series compatible

ITEM NUMBER	651522	651523	651524	651525	651526
DIAMETER	35.0	50.0	75.0	100.0	125.00
CAPACITY	75	50	75	100	110
A	M10 x 30	M10 x 30	M10 x 30	M10 x 30	M10 x 30
B	25.0	18.0	23.0	32.0	32.0
C	60.0	69.0	98.0	133.0	158.0
OIL RESISTANCE	Average	Average	Average	Average	Average
WHEEL COLOR	Black	Black	Black	Black	Black
LBS	.13	.13	.19	.48	.58
BRAKE	No	Yes	Yes	Yes	Yes
MOUNTING PLATE COMPATIBILITY	SEE PAGES 12:38 & 12:39 25 & 40 SERIES				

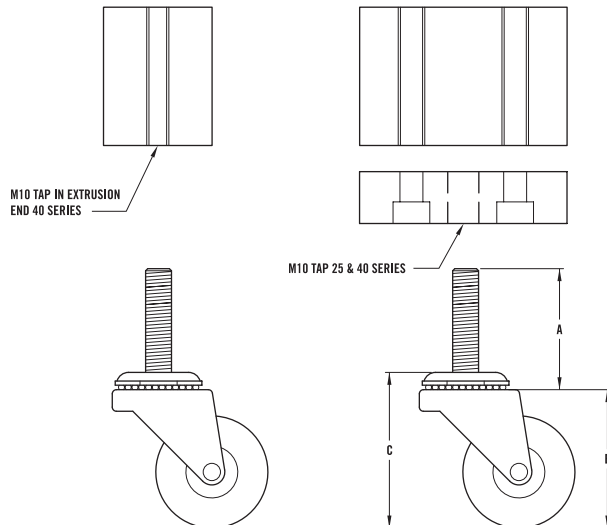

ECONOMY LEVELING FEET



ITEM #	DESCRIPTION
651527	M6 x 1.0 Economy Leveling Foot
651528	M8 x 1.25 Economy Leveling Foot
651529	M10 x 1.5 Economy Leveling Foot
651530	M12 x 1.75 Economy Leveling Foot

- Threads directly into extrusion end or into 25 and 40 Series base plates
- Jam nut included
- 1050 lb. to 4700 lb. capacity
- 10 and 15 Series sizes

» Tap machining service required to load extrusion end. See page 11:06.

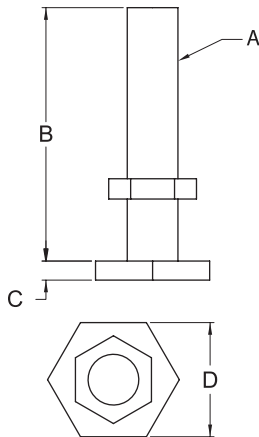

ITEM #	651527	651528	651529	651530
A	M6 x 1.0	M8 x 1.25	M10 x 1.5	M12 x 1.74
B	30.0	40.0	60.0	65.0
C	2.40	3.10	3.70	4.40
D	14.0	18.0	22.0	25.0
LOAD CAPACITY	475 kg	790 kg	1150 kg	2130 kg

NYLON LEVELING FEET



ITEM #	DESCRIPTION
655783	M8 Nylon Leveling Foot
655790	M10 Nylon Leveling Foot
655798	M12 Nylon Leveling Foot

ITEM #	655783	655790	655798	655869
A	M8	M10	M12	M16
B	58.0	63.0	84.0	84.0
C	39.0	59.0	79.0	99.0
D	18.0	18.0	18.0	18.0
LOAD CAPACITY	350 kg	470 kg	770 kg	1450 kg

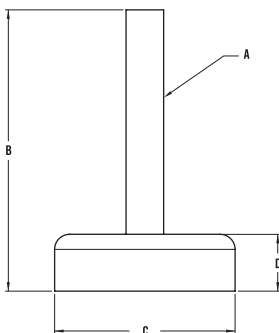

DELUXE LEVELING FEET



ITEM #	DESCRIPTION
651531	M6 x 1.0 Deluxe Leveling Feet
651532	M8 x 1.25 Deluxe Leveling Feet
651533	M10 x 1.50 Deluxe Leveling Feet
651534	M12 x 1.75 Deluxe Leveling Feet
651535	M16 x 2.0 Deluxe Leveling Feet

- Threads directly into extrusion end or into 25 and 40 Series base plates
- Jam nut included
- Pivots 20 degrees to accommodate uneven floors
- 1000 lb. to 7400 lb. capacity
- 10 and 15 Series sizes



» Tap machining service required to load extrusion end. See page 11:06.

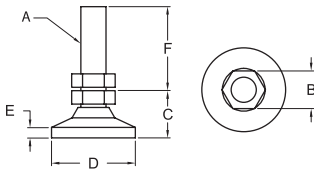

ITEM #	651531	651532	651533	651534	651535
A	M6 x 1.0	M8 x 1.25	M10 x 1.50	M12 x 1.75	M16 x 2.0
B	10.0	13.0	16.0	19.0	22.0
C	14.0	18.0	22.0	29.0	32.0
D	19.0	26.0	32.0	48.0	64.0
E	25.0	32.0	51.0	51.0	51.0
F	24.0	31.0	51.0	50.0	51.0
LOAD CAPACITY	317 kg	453 kg	1701 kg	2268 kg	2721 kg

DIE CAST LEVELING FEET



ITEM #	DESCRIPTION
655779	M8 Die Cast Leveling Foot
655786	M10 Die Cast Leveling Foot
655794	M12 Die Cast Leveling Foot
655806	M16 Die Cast Leveling Foot
655802	M12 Die Cast Leveling Foot w/ Holes
655814	M16 Die Cast Leveling Foot w/ Holes

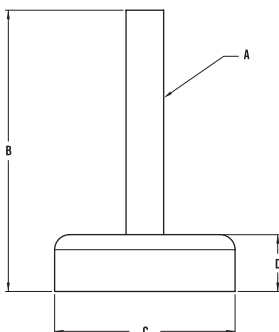

ITEM #	655779	655786	655794	655806	655802	655814
A	M8	M10	M12	M16	M12 (w/holes)	M16 (w/holes)
B	58.0	63.0	84.0	84.0	84.0	84.0
C	29.0	39.0	59.0	59.0	79.0	99.0
D	18.0	18.0	18.0	18.0	18.0	18.0
LOAD RATING	350 Kg	470 Kg	770 Kg	1450 Kg	770 Kg	1450 Kg

25 SERIES BASE PLATES

ITEM #	DESCRIPTION	BOLT KIT TO T SLOT	MOUNT IN EXTRUSION END
664058	25S 25mm x 50mm M6 x 1.0	(2) 651509	(2) 651337
664059	25S 25mm x 50mm M8 x 1.25	(2) 651509	(2) 651337
664060	25S 25mm x 50mm M10 x 1.5	(2) 651509	(2) 651337
664061	25S 25mm x 50mm M12 x 1.75	(2) 651509	(2) 651337
655662	25S 50mm x 50mm Blank	(2) 651509	(2) 651337
664062	25S 50mm x 50mm M10 x 1.5	(4) 651509	(4) 651337
664063	25S 50mm x 50mm M12 x 1.75	(4) 651509	(4) 651337
664064	25S 50mm x 50mm M16 x 2.0	(4) 651509	(4) 651337
664065	25S 50mm x 50mm M20 x 2.25	(4) 651509	(4) 651337
655663	25S 50mm x 50mm Blank	(4) 651509	(4) 651337

- Mounts leveling feet and threaded stem casters to T-SLOTS
- Bolts in extrusion end or in T-Slot
- See page 12:36 for leveling feet
- See page 12:35 for threaded stem casters

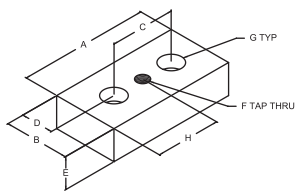

ITEM #	LBS	A	B	C	D	E	F	G	H
664058	.085	50.8	25.4	25.4	12.7	12.7	M6	DRILL THRU & C-BORE FOR M6	25.4
664059	.085	50.8	25.4	25.4	12.7	12.7	M8	DRILL THRU & C-BORE FOR M6	25.4
664060	.080	50.8	25.4	25.4	12.7	12.7	M10	DRILL THRU & C-BORE FOR M6	25.4
664061	.078	50.8	25.4	25.4	12.7	12.7	M12	DRILL THRU & C-BORE FOR M6	25.4
655662	.090	50.8	25.4	25.4	12.7	12.7	N/A	DRILL THRU & C-BORE FOR M6	25.4

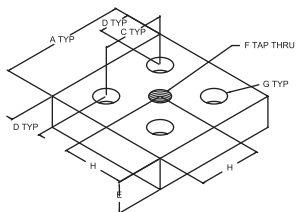

ITEM #	LBS	A	B	C	D	E	F	G	H
664062	.175	50.8	N/A	25.4	12.7	12.7	M10	DRILL THRU & C-BORE FOR M6	25.4
664063	.170	50.8	N/A	25.4	12.7	12.7	M12	DRILL THRU & C-BORE FOR M6	25.4
664064	.170	50.8	N/A	25.4	12.7	12.7	M16	DRILL THRU & C-BORE FOR M6	25.4
664065	.160	50.8	N/A	25.4	12.7	12.7	M20	DRILL THRU & C-BORE FOR M6	25.4
655663	.180	50.8	N/A	25.4	12.7	12.7	N/A	DRILL THRU & C-BORE FOR M6	N/A

40 SERIES BASE PLATES

ITEM #	DESCRIPTION	BOLT KIT TO T SLOT	MOUNT IN EXTRUSION END
655657	40S 40mm x 80mm Base Plate Blank		
664043	40S 40mm x 80mm Base Plate w/ 8mm Tap In Center	(2) 651426	(2) 651350
660146	40S 40mm x 80mm Base Plate w/ 10mm Tap In Center	(2) 651426	(2) 651350
664044	40S 40mm x 80mm Base Plate w/ 12mm Tap In Center	(2) 651426	(2) 651350
664045	40S 40mm x 80mm Base Plate w/ 16mm Tap In Center	(2) 651426	(2) 651350
664046	40S 80mm x 80mm Base Plate w/ 8mm Tap In Center	(4) 651426	(4) 651350
664047	40S 80mm x 80mm Base Plate w/ 10mm Tap In Center	(4) 651426	(4) 651350
664048	40S 80mm x 80mm Base Plate w/ 12mm Tap In Center	(4) 651426	(4) 651350
664031	40S 80mm x 80mm Base Plate w/ 16mm Tap In Center	(4) 651426	(4) 651350

- Mounts leveling feet and threaded stem casters to T-SLOTS
- Bolts in extrusion end or in T-Slot
- See pages 12:36 for leveling feet
- See pages 12:35 for threaded stem casters
- Die Cast Black

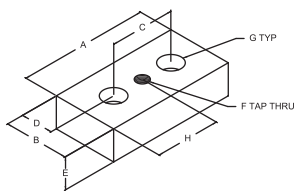

ITEM #	LBS	A	B	C	D	E	F	G	H
655657	.136	80.0	40.0	40.0	20.0	16.0	N/A	N/A	N/A
664043	.136	80.0	40.0	40.0	20.0	16.0	8mm	DRILL THRU & C-BORE FOR M8-1	38.1
660146	.136	80.0	40.0	40.0	20.0	16.0	10mm	DRILL THRU & C-BORE FOR M8-1	38.1
664044	.136	80.0	40.0	40.0	20.0	16.0	12mm	DRILL THRU & C-BORE FOR M8-1	38.1
664045	.129	80.0	40.0	40.0	20.0	16.0	16mm	DRILL THRU & C-BORE FOR M8-1	38.1

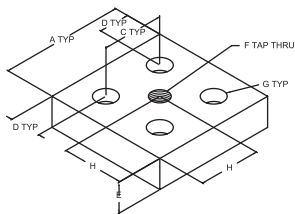

ITEM #	LBS	A	B	C	D	E	F	G	H
664046	.272	80.0	N/A	40.0	20.0	16.0	8mm	DRILL THRU & C-BORE FOR M8-1	38.1
664047	.272	80.0	N/A	40.0	20.0	16.0	10mm	DRILL THRU & C-BORE FOR M8-1	38.1
664048	.263	80.0	N/A	40.0	20.0	16.0	12mm	DRILL THRU & C-BORE FOR M8-1	38.1
664031	.263	80.0	N/A	40.0	20.0	16.0	16mm	DRILL THRU & C-BORE FOR M8-1	38.1



BASE PLATES - FLOOR MOUNT 40 SERIES ECONOMY



655276

ITEM #	DESCRIPTION
655276	40 S 1.5" Economy Floor Mount Base Plate
664016	40 S 80mm x 80mm Economy Floor Mount

BOLT KIT TO MOUNT TO T SLOT
(2) 651506
(4) 651506

- Strong economy base plates
- Bolts directly in the T-Slot
- Allows vertical adjustments
- More economical than standard Floor Mount Base Plate



664016

ITEM #	655276	664016
A	127	127
B	80	80
C	40	40
D	N/A	40
E	6.3	6.3
F	50.8	50.8
G	17.5	17.5
H	N/A	40
J	40	80
K	8.3	8.3
L	13.5	13.5
M	28.5	28.5
N	20	20
LBS	.131	.262

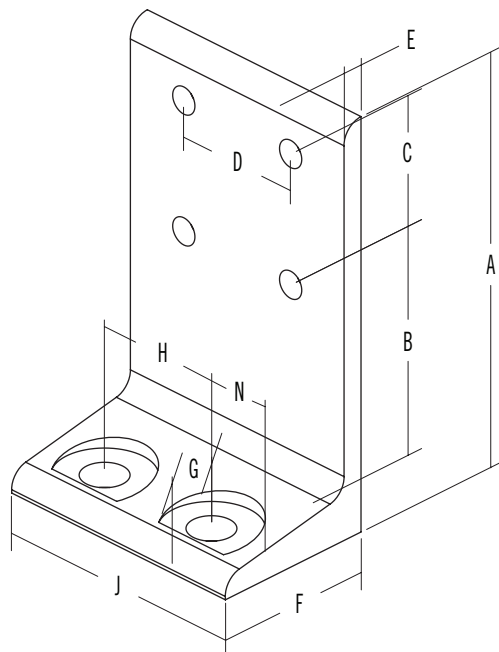

FLANGE MOUNT CASTER BASE PLATE



ITEM #	DESCRIPTION
655279	10 S / 25 S Flange Mount Caster Base Plate
655280	10 S / 25 S Flange Mount Caster Base Plate
664067	40 S Flange Mount Caster Base Plate
664068	40 S Flange Mount Caster Base Plate



RECOMMENDED FASTENERS TO MOUNT TO EXTRUSION T-SLOT

BASE PLATE PART #	655279	655280	664067	664068
651537			4	4
651503	4	4		

RECOMMENDED FASTENERS TO MOUNT TO EXTRUSION END

BASE PLATE PART #	655279	655280	664067	664068
651350			4	4
651337	4	4		

- Mounts Flange Mount Caster and Deluxe Flange Mount Caster to extrusion
- Mount Base Plate to either extrusion end or slot
- 25 and 40 Series sizes

» See page 06:33 - 06:35 for casters.

25 SERIES

ITEM #	655279	655280
A	63.5	63.5
B	12.70	12.70
C	95.25	95.25
D	74.676	74.676
E	10.287	10.287
F	9.525	9.525
G	44.45	44.45
H	34.925	34.925
J	25.4	25.4
L	19.05	19.05
LBS	.19 kg	.19 kg
M	M8 TAP THRU	
N	DRILL THRU & C-BORE M6 SHCS	

40 SERIES

ITEM #	664067	664068
A	76.2	76.2
B	19.05	19.05
C	95.25	95.25
D	74.676	74.676
E	10.287	10.287
F	15.875	15.875
G	44.45	44.45
H	27.625	27.625
J	40.00	40.00
L	11.75	11.75
LBS	.34 kg	.34 kg
M	M8 TAP THRU	
N	DRILL THRU & C-BORE M8 SHCS	

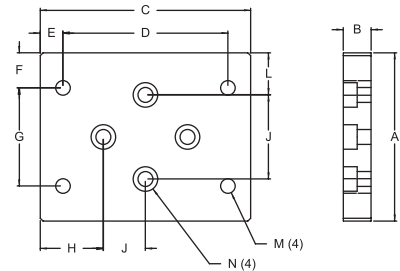
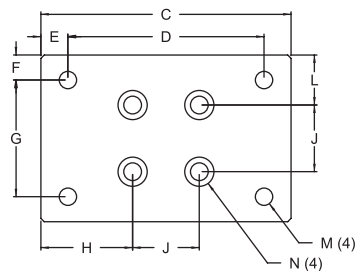

END CAPS



ITEM #	DESCRIPTION
655000	1010 / 2525 End Cap Black
655010	1020 / 2550 End Cap Black
655020	2020 / 5050 End Cap Black
655015	1030 / 2575 End Cap Black
659054	4040 End Cap Black
659055	4080 End Cap Black
659057	8080 End Cap Black

- Allows you to cap off extrusion ends
- Push in fasteners included
- Can be mounted with M6 or M8 fasteners
- 25 and 40 Series sizes

TSLOT COVERS

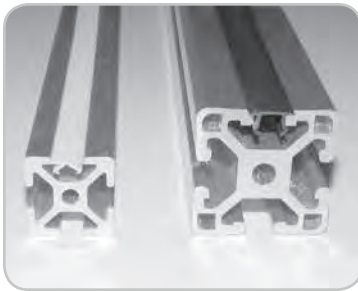

10 & 15 SERIES ECONOMY

ITEM #	DESCRIPTION
655105	15 S Black T-Slot Cover 15S 40S
655106	15 S Gray T-Slot Cover 15S 40S

- Stocked in 8' lengths

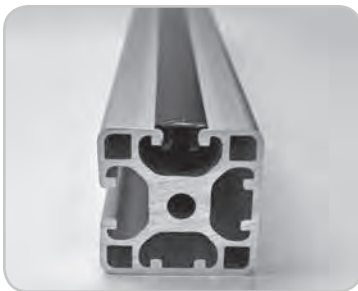

15 SERIES DELUXE

ITEM #	DESCRIPTION
655520	10 S Yellow T-Slot Cover 10S
655521	10 S Black T-Slot Cover 10S
655522	10 S Gray T-Slot Cover 10S
655523	15 S Yellow T-Slot Cover 15S 40S
655524	15 S Black T-Slot Cover 15S 40S
655525	15 S Gray T-Slot Cover 15S 40S

- Stocked in 6' lengths
- Covers T-Slot to keep dust and dirt out
- Covers wires and tubes in T-Slot

LIFT OFF HINGES



ITEM #	DESCRIPTION
655776	40 S Right Hand Lift Off
655775	40 S Left Hand Lift Off

ITEM #	A1	A2	A3	A4
655776	22.5	22.5	38.5	38.5
655775	22.5	22.5	38.5	38.5

RECOMMENDED FASTENERS

651516 & 651366 M6 x 16 mm FHSCS & M6 Economy T-Nut

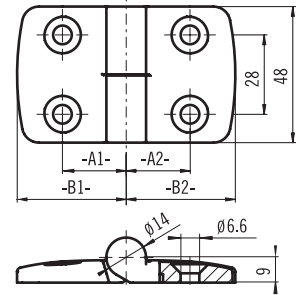

PIVOT JOINT



ITEM #	DESCRIPTION
664084	10 S / 25 S Pivot Joint
664085	10 S / 25 S Pivot Joint w/ Locking Handle
664088	40 S Pivot Joint
664089	40 S Pivot Joint w/ Locking Handle

RECOMMENDED FASTENERS (TO EXTRUSION SLOT)

10 S / 25 S	651334 & 651386	M6 x 16mm SHCS & Economy T-Nut
40 S	651512	M8 x 16mm SHCS & Economy T-Nut

RECOMMENDED FASTENERS (TO EXTRUSION END)

10 S / 25 S	651337	M6 x 20mm SHCS
40 S	651346	M8 x 20mm SHCS

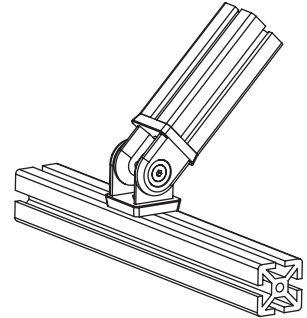

40 S CONNECTOR ANGLE



ITEM #	DESCRIPTION
655767	40 S 45° Connection Angle

RECOMMENDED FASTENERS

SLOT	651512	M8 x 16mm SHCS & Economy T-Nut
END	651350	M8 x 25mm SHCS



ADJUSTABLE ANGLE



ITEM # DESCRIPTION
664110 40 S Adjustable Angle 40, 36 x 36 x 32, Die-Cast Zinc

RECOMMENDED FASTENERS

651512 M8 x 16mm SHCS & Economy T-Nut

